



# Saving space for saving lives.

## Integrated Power Center 2 (IPC2) prefabricated gear for healthcare



### Space savings

Panels are stacked above the transformer, reducing up to 40% of the overall footprint and saving valuable floor and wall space. Reduce the size of your electrical room and increase space for more important uses such as patient care and medical equipment.

### Labor savings

Panels and transformers are factory mounted, assembled, and cabled in a single enclosure, which means installation can take hours rather than days. It also minimizes contractor labor risk due to reduction in installation hours.

### Reduce material cost and handling

The solution requires fewer items to receive, inventory, retrieve, and install. Wiring between the internal components of the section is done at the factory, saving labor and eliminating conduit, wire, and fittings.

### Meets/complies with NEC and UL

The IPC2 transformer combo is designed and manufactured to comply with National Electrical Code® (NEC) and UL requirements. Electrical distribution equipment is factory assembled and tested in a controlled factory environment, ensuring the highest quality standards are met.

# Specifications

## Standard construction

- UL 891 - deadfront switchboard
- Seismically qualified to meet IBC and ASCE 7 and OSHPD requirements
- Panelboard deadfront access door with keyed door lock
- Hinged wire gutter access door with 135° door swing
- Front and rear-aligned sections, available in multiple widths
- Top and bottom conduit entry/exit spaces available
- Powerlink™ lighting control solutions
- PowerLogic™ power monitoring and control

## Enclosure options

- NEMA 1 indoor
- NEMA 1 with driphood
- NEMA 3R rainproof

## Panelboards

- NQ 600A MLO max. and 600A Main Breaker max.
- NF 600A MLO and 600A Main Breaker max.
- I-Line 1200A MLO max. and 1200A Main Breaker max.

## Transformer

- Energy Efficient
  - 15kVA-300kVA three phase 150° C Rise
  - 15kVA-167kVA single phase 150° C Rise
- K-4 and K13 non linear options available

## Automatic transfer switch

- 400A 3 pole maximum
- Open transition



Traditional electrical installation

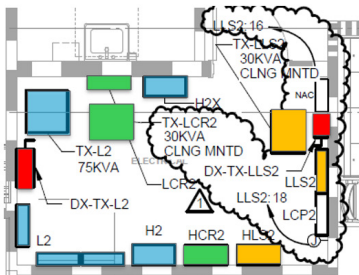

Prefabricated = space savings

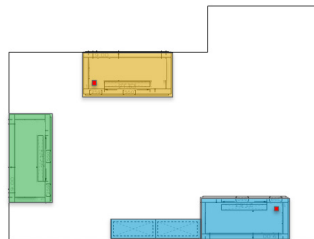

Learn how to maximize space at your facility:  
Email [quotes4powersolutions@se.com](mailto:quotes4powersolutions@se.com)



Scan the QR code for a healthcare solutions video!

[se.com/us/ipacs](http://se.com/us/ipacs)

Life Is On

**Schneider**  
Electric

Schneider Electric  
105 Summit Park Dr.  
Salisbury, NC 28146  
888-SquareD (888-778-2733)